

|  |  |  |   |              |
|--|--|--|---|--------------|
| <b>05/18/2026 05:51 OWNERSHIP 621052000</b>  | <b>PROPERTY DESCRIPTION</b>  | <b>TAX DESCRIPTION</b>                 | <b>MAP NUMBER</b>   | <b>CARD#</b> |
| CORMIER JOSEPH D<br>CORMIER DONNA W<br>MAIL RETURNED<br>/ DEED: 00464 0210 5/12/2022 \$430,000 | MYERS CHAPEL RD<br><br>PLATBOOK/PAGE/DATE:<br>NB: 20001 HAYESVILLE TWNSP<br>1654 MYERS CHAPEL RD | HAYESVILLE<br>HAYESVILLE FIRE DISTRICT | 556017104707<br>RECORD NUMBER: 15697<br>ROUTE: 556017 027<br>LISTER: JASON COLLIER 1/1/2026<br>REVIEWER: JASON COLLIER 3/5/2024 | 1 / 1        |

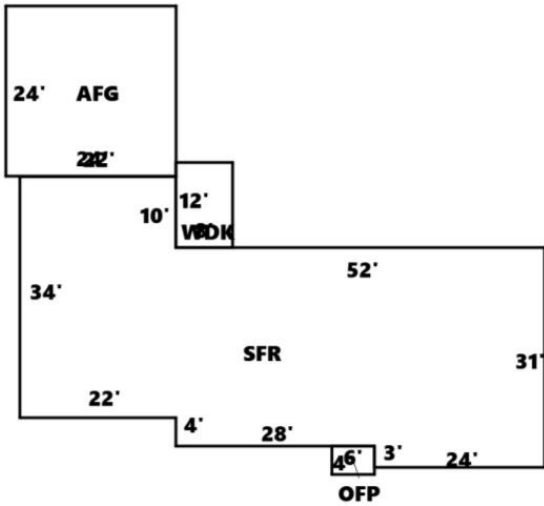

| TOPO                         |                        | STREET                  |          | UTILITIES                            |          | NOTES      |         |                       |  | AC     |
|------------------------------|------------------------|-------------------------|----------|--------------------------------------|----------|------------|---------|-----------------------|--|--------|
|                              |                        |                         |          |                                      |          |            |         |                       |  | 2.9400 |
| #                            | LAND CLASS             | SIZE                    | BASERATE | * ACF                                | * ADJ    | = ADJ RATE | * UNITS | = LNDVALUE            |  |        |
| 1                            | 11HOMESITE-PAVED       | 1.000                   | 39000    | 1.00                                 | 1.00     | 39000      | 1.000   | 39000                 |  |        |
| 2                            | 21OPEN LAND-PAVED      | 1.000                   | 10000    | 1.00                                 | 1.00     | 10000      | 1.000   | 10000                 |  |        |
| 3                            | 41WOOD LAND-PAVED      | 0.940                   | 10000    | 1.00                                 | 1.00     | 10000      | 0.940   | 9400                  |  |        |
| <b>ACREAGE FACTOR:</b>       |                        | <b>FRONTAGE FACTOR:</b> |          | <b>LAND VALUE</b>                    |          |            |         | <b>58,400</b>         |  |        |
| #                            | OTHER FEATURES         | SIZE                    | BASERATE | COND                                 | ADJ RATE | UNITS      | VALUE   |                       |  |        |
| 1                            | 17 C GARAGE UNFINISHED | 30 * 48                 | 25.00    | 0.00                                 | 25.00    | 1440       | 36000   |                       |  |        |
| 2                            | 34 C SHOP              | 12 * 14                 | 20.00    | 0.00                                 | 20.00    | 168        | 3400    |                       |  |        |
| <b>OTHER FEATURES VALUE:</b> |                        |                         |          |                                      |          |            |         | <b>39,400</b>         |  |        |
| FOUNDATION                   |                        | XTR_FINISH              |          | ROOF TYPE                            |          | ROOF MTRL  |         | SIZE/QTY              |  |        |
| 1 CRAWL SPACE                |                        | 02 BRICK                |          | 02 GABLE                             |          | 01 ASPHALT |         | 1.0000 SHTT<br>3 BDRM |  |        |
| WALL FINISH                  |                        | FLOORS                  |          | HEAT&AIR                             |          | HEAT FUEL  |         | BUILDING #            |  |        |
| 01 DRYWALL<br>02 PANELING    |                        | 05 CARPET<br>10 VINYL   |          | 11 CENTRAL AIR CONDI<br>04 HEAT PUMP |          | 05 ELEC    |         | 1                     |  |        |

|                          |               |             |           |           |                    |             |              |
|--------------------------|---------------|-------------|-----------|-----------|--------------------|-------------|--------------|
| <b>IMPROVEMENT TYPE:</b> | SINGLE FAMILY | GRADE: C+10 | AYB: 1959 | EYB: 1959 | CONDITION: Average | DEPR TABLE: | SQ FT TABLE: |
|--------------------------|---------------|-------------|-----------|-----------|--------------------|-------------|--------------|

**DIMENSIONS:** SFR=W24N3W28N4W22N34E22S10E52S31Area:2276;AFG=N24E24S24W24Area:576;OFF=W6S4E6N4Area:24;WDK=E8N12W8S12Area:96;TotalArea:2972

| STRUCTURE             | SKETCH-SF | * STHT | = AREA | RATE   | * GRDE | + HEAT | + EXWL | * WLHT | = ADJRATE | * AREA | = RPCN | * DEPF | * CNDF | = STR-VALUE |
|-----------------------|-----------|--------|--------|--------|--------|--------|--------|--------|-----------|--------|--------|--------|--------|-------------|
| SFR SFR SINGLE FAMILY | 2276      | 1.00   | 2276   | 161.10 | C 1.10 | 5.50   | 3.00   | 1.00   | 185.71    | 2276   | 422676 | 0.33   |        | 139483      |
| 66%UNF-BSMT           | 0         |        | 1502   | 32.22  | 1.10   |        |        |        | 35.44     | 1502   | 53231  | 0.33   |        | 17566       |
| 2 BATHS               | 0         |        | 0      |        |        |        |        |        | 7398.00   | 0      | 14796  | 0.33   |        | 4883        |
| 1 HALFBATHS           | 0         |        | 0      |        |        |        |        |        | 3950.00   | 0      | 3950   | 0.33   |        | 1304        |
| AFG AFG ATTACHED      | 576       | 1.00   | 576    | 58.00  | 1.10   |        |        | 1.00   | 63.80     | 576    | 36749  | 0.33   |        | 12127       |
| WDK WDK WOOD DECK     | 96        | 1.00   | 96     | 13.00  | 1.10   |        |        | 1.00   | 14.30     | 96     | 1373   | 0.33   |        | 453         |
| OFF OFF OPEN FINISHED | 24        | 1.00   | 24     | 100.00 | 1.10   |        |        | 1.00   | 110.00    | 24     | 2640   | 0.33   |        | 871         |

2852 HSF 4474 TSF RPCN=187.7331/HSF 535415 VALU=61.95/HSF 176687

**STRUCTURE VALUE 176,700**

**CARD 1 VALUE 274,500**

| VALUATION    | THIS CARD      | + OTHER CARD | = VALUE        | PREV-VAL       | CHANGE     | OTHER CARDS VALUE   |
|--------------|----------------|--------------|----------------|----------------|------------|---------------------|
| LAND         | 58,400         |              | 58,400         | 44,600         | 30.94%     | TOTAL VALUE 274,500 |
| OTHER FEAT   | 39,400         |              | 39,400         | 39,400         | %          |                     |
| STRUCTURE    | 176,700        |              | 176,700        | 156,800        | 12.69%     |                     |
| <b>TOTAL</b> | <b>274,500</b> |              | <b>274,500</b> | <b>240,800</b> | <b>14%</b> |                     |

**NBHD ADJUSTMENT: 1.00 \* 274500 = 274,500**

**APPRaised VALUE 274,500**

**TAXABLE VALUE 274,500**

(1051580) Group:0 TAX YEAR: 2026 DEFERRED VALUE 0

Clay County, NC REVAL YEAR: 2026